

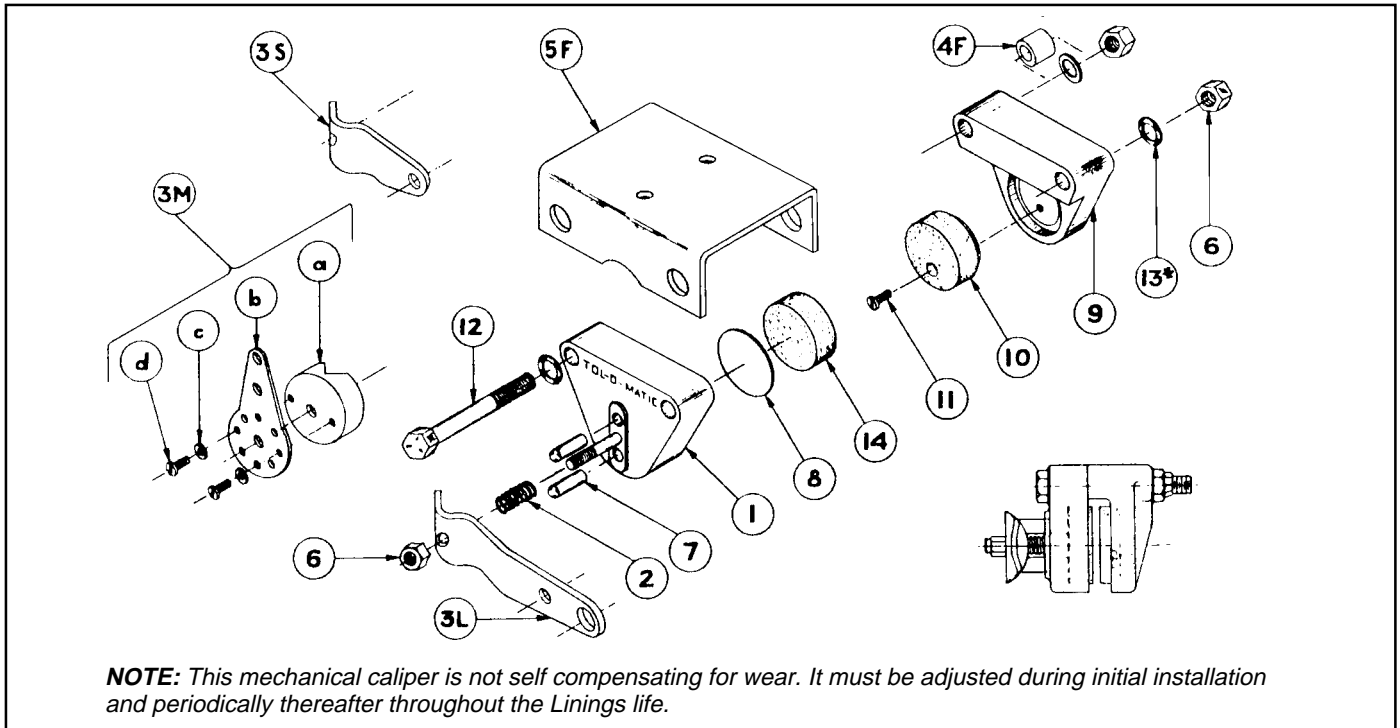

Mechanically-actuated Brake

ME10 Series
Die-cast Aluminum

Models:	ME10MA	0707-0000
	ME10MAF	0707-0001
	ME10SA	0732-0000
	ME10SAF	0732-0001
	ME10LA	0732-0003
	ME10LAF	0732-0002



NOTE: This mechanical caliper is not self compensating for wear. It must be adjusted during initial installation and periodically thereafter throughout the Linings life.

Parts List

ITEM	PART NO.	DESCRIPTION	ASSEMBLY/ MODEL NO.					
			ME10MA	ME10MAF	ME10SA	ME10SAF	ME10LA	ME10LAF
1	0707-1002	Live Side Housing	1	1	1	1	1	1
2	0707-1004	Compression Spring	1	1	1	1	1	1
3.	0707-1006	3a. Brake Cam	1	1				
	0707-1007	3b. Lever Arm	1	1				
	0707-1011	3c. Lock Washer #10	2	2				
	0707-1012	3d. Pan Head Screw	2	2				
3.S	0707-1013	Lever Cam (1.75)			1	1		
3.L	0743-1013	Lever Cam (3.50)					1	1
4.	0707-1015	Sleeve	4		4		4	
5.	0707-1016	Floating Mount Bracket		1		1		1

ITEM	PART NO.	DESCRIPTION	ASSEMBLY/ MODEL NO.					
			ME10MA	ME10MAF	ME10SA	ME10SAF	ME10LA	ME10LAF
6.	0701-1008	Nut	1	1	1	1	1	1
7.	0707-1005	Actuating Pin	2	2	2	2	2	2
8.	0707-1003	Back Plate	1	1	1	1	1	1
9.	0705-1011	Dead Side Housing	1	1	1	1	1	1
10.	0701-1032	Dead Side Puck	1	1	1	1	1	1
11.	0701-1006	Flat Head Screw	1	1	1	1	1	1
12.	0707-1105	Hex Head Bolt	2		2		2	
	0705-1106	Hex Head Bolt		2		2		2
13.	0701-1007	Flat Washer	4		4		4	
14.	0701-1010	Live Side Puck	1	1	1	1	1	1

NOTE: Items marked with capital letters are used only in those models with the corresponding suffix letters. **A** – designed for a 5/32" (3.97mm) thick disc; **M** – machined length lever; **S** – short lever; **L** – long lever.

INSTALLATION

1. Disconnect the Brake Lever Arm (#3) from its linkage.
2. Remove the brake or the brake and mounting bracket from its mounting area.
3. Unbolt the two Hex Head Bolts (#12) and take the two halves of the brake apart.
4. Remove the Flat Head Screw (#11) from the Dead Side Puck (#14) and place it aside. Then, remove both pucks (#10 and #14).
5. Take the Flat Head Screw (#11), spreading Loctite® on its threads. Then, use it to install the new new Dead Side Puck (#14) into the Dead Side Housing (#9), torquing it to 20 inch-pounds (2.26 Nm) (23.04 Kg/Cm).
6. When reassembling the brake, lubricate the Actuating Pins (#7) with a dry graphite lubricant. Then reinstall the two Hex Head Bolts (#12), with the four Washers (#13*) and the two Lock Nuts (#6) and torque to 480 inch-pounds (54.23 Nm) (552.96 Kg/Cm).
7. Mount the brake unit back in its location with two SAE Grade 5 Hex Head Bolts, torquing to 264 inch-pounds (29.83 Nm) (304.128 Kg/Cm).
8. Care must be taken in mounting the brake to make certain the puck faces are parallel to the disc. The proper clearance between each puck and each side of the disc is 0.010 inch (0.254 mm) to 0.031 inch (0.787 mm).
9. To prevent excessive wear, be certain the disc does not rub against the brake housing or against the pucks while they are in the retracted position.
10. The disc must be free of dirt and grease for maximum life and braking action.
11. The maximum allowable lever force is 225 pounds (100.45 Kg) for the 3.50" (8.89 cm) long lever arm (#3L) and 450 pounds (200.89 Kg) for both of the other levers (#3S and #3M).

Loctite® is a registered trademark of the Loctite Corporation, Newington, Connecticut.

MOUNTING DIMENSIONS

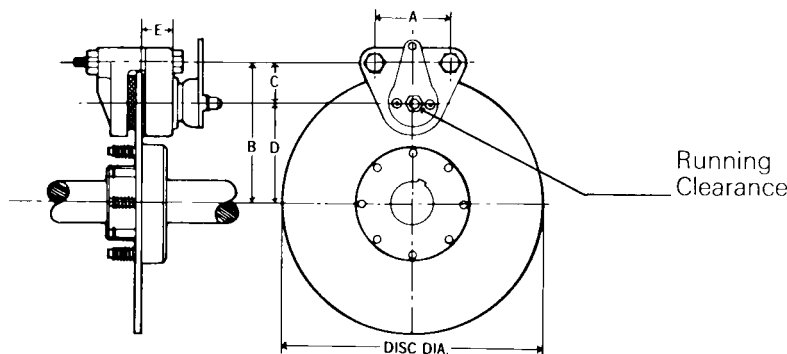

DISC DIA	A	B	C	D	E
6.3125	1.625	3.46875	0.9375	2.53125	0.75
8	1.625	4.3125	0.9375	3.375	0.75
10	1.625	5.3125	0.9375	4.375	0.75
12	1.625	6.3125	0.9375	5.375	0.75
16	1.625	8.3125	0.9375	7.375	0.75

Above dimensions in inches

DISC DIA	A	B	C	D	E
160.3	41.3	88.1	23.8	64.3	19.1
203.2	41.3	109.5	23.8	85.7	19.1
254.0	41.3	134.9	23.8	111.1	19.1
304.8	41.3	160.3	23.8	136.5	19.1
406.4	41.3	211.1	23.8	187.3	19.1

Above dimensions in millimeters



TOL-O-MATIC, INC.

3800 County Road 116, Hamel, MN 55340

http://www.Tolomatic.com • Email: Help@Tolomatic.com

Phone: (763) 478-8000 • Fax: (763) 478-8080 • Toll Free: 1-800-328-2174



Information furnished is believed to be accurate and reliable. However, Tol-O-Matic assumes no responsibility for its use or for any errors that may appear in this document. Tol-O-Matic reserves the right to change the design or operation of the equipment described herein and any associated motion products without notice. Information in this document is subject to change without notice.